



ARCHITECTURAL

MILLWORK OF SANTA BARBARA, INC.  
MANUFACTURERS OF WOOD PRODUCTS  
STATE LICENSE NO. 261772

PHONE: 805.965.7011

MILL FAX: 805.564.8466

CABINET FAX: 805.965.0501

8 NORTH NOPAL STREET • P.O. BOX 4699 • SANTA BARBARA, CALIF. 93140-4699

## Maintenance and Service of Architectural Millwork Concealed Roll Down Screen Window Patent Number: 6,123,135

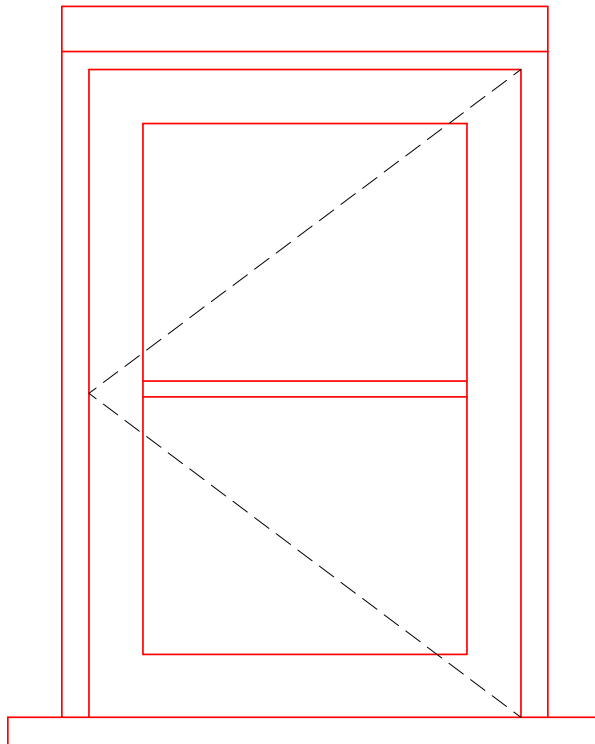

Elevation

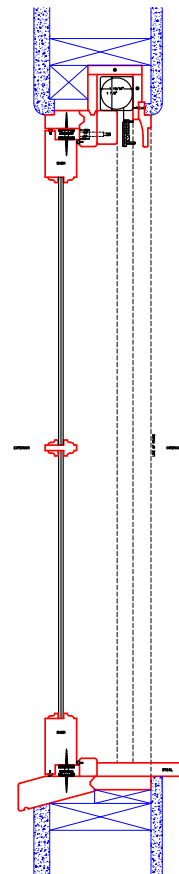

**Maintenance – There is no necessary maintenance required under normal operating conditions.**

Should a screen become damaged or fail to retract, carefully remove screen box and return to Arch. Mill. for repair. Please follow instructions below.

## Service of Concealed Roll Down Screens

1 – It is not necessary but it will be easier if the screen is retracted into the top of the frame. If not, carefully hold the screen to the side and follow the steps below.

2 – (Figure 1) Carefully pry jamb liner E from the jamb (A) using a flat bar. Jamb liner E is held in place with spring loaded ball catches. Light pressure should lift part E from the jamb (A). Care should be used not to damage part E or the jamb (A). There should be no screws or caulking restraining part E. If either has been added, they will need to be removed prior to prying part E from the jamb (A). Once the ball catches are released part E can be removed from the bottom working up. Repeat on the opposite side.

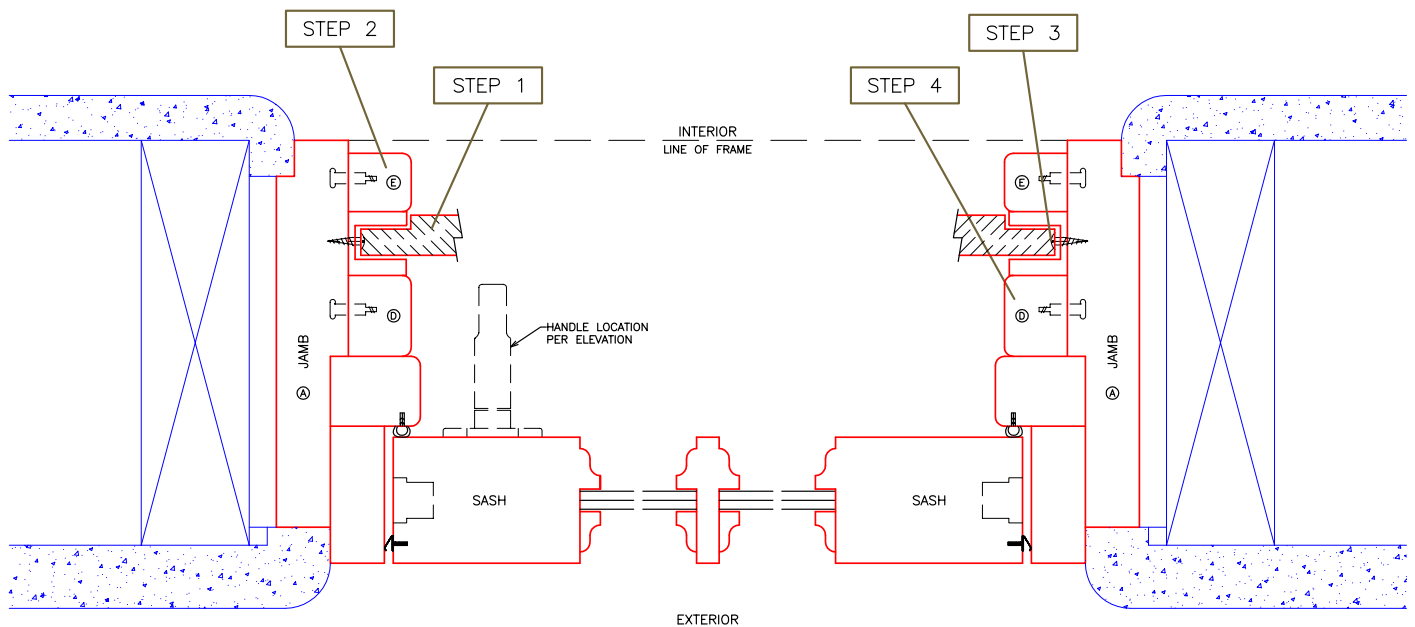

Figure 1 - Horizontal Cross Section

3 - Using a small size screw driver, carefully remove the screws restraining the aluminum guide channel. There are screws at the top, middle and bottom. Insert the screw driver between the two sides of fuzzy weather-strip, carefully feel for the screw head and unscrew each screw. Once the screws are removed, the guide channel can be removed from the bottom working up. Repeat on the opposite side.

4 – Carefully pry jamb liner D (figure 1) from the jamb using a flat bar. Jamb liner D is held in place with spring loaded ball catches. Light pressure should lift part D from the jamb. Care should be used not to damage part D or the jamb. There should be no screws or caulking restraining part D. If either has been added, they will need to be removed prior to prying part D from the jamb. Once the ball catches are released part D can be removed from the bottom working up. Repeat on the opposite side.

5 – In order to remove Screen Rail K, it is necessary to open the sash. There are two concealed bolts on the exterior side of fixed rail G about 3 inches from each jamb (see figure 2). Using a 4 mm or 5/32" long handled Allen wrench, carefully unbolt rail K. Care should be used not to fall out of the open window. Rail K and the screen box will slide downward out of the window frame pocket.

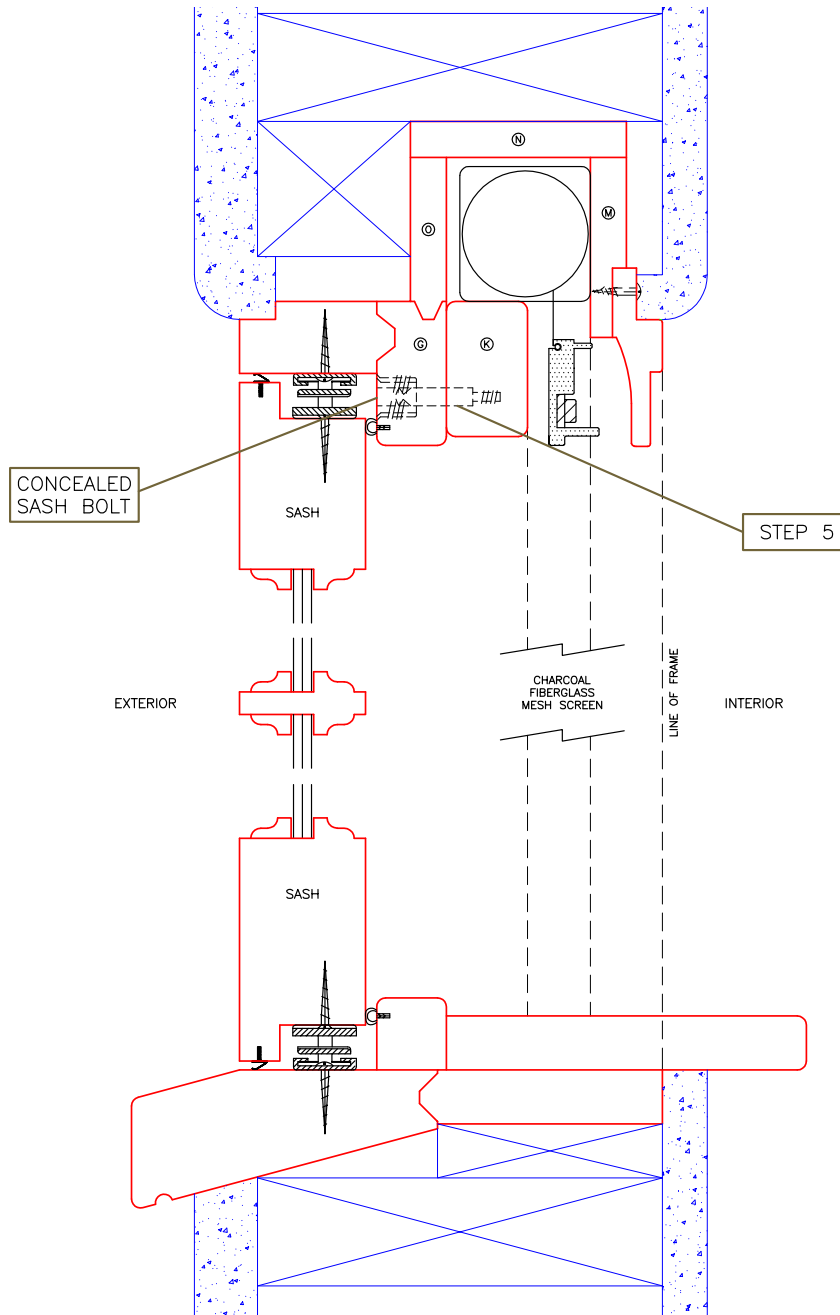

Figure 2 - Vertical Cross Section

6 – Send the screen to Arch. Mill. for repair.

7 – To reinstall the roll down screen, follow steps 5 to 2 in reverse order.